

# MODEL JKW-350 SUPERBUTE™

## Outdoor Current Transformer

69 kV, 60 Hz,  
350 kV BIL



When choosing your GE Vernova Instrument Transformer, don't forget to explore the benefits of using GE Vernova's 0.15 accuracy class AccuBute line.

### Application

Designed for outdoor service; suitable for operating meters, relays, and control devices. Rated Station Class with higher burden and extra creep distance. Available in a variety of ratio as outlined in the unit selection table below, with additional designs available upon request.

### Features

- Weight (Shipping/Unit): 683/593 lbs
- Creep Distance: 86.61" [2200 mm]
- 1-sec Thermal Limit: 75x normal
- 2 cycle Mechanical Limit: 170x rated (low ratio)
- 2 cycle Mechanical Limit: 85x rated (high ratio)
- Insulation: HY-BUTE 60™ Butyl Rubber
- Insulation Class: 350 kV BIL, Outdoor
- Design Standard: IEEE C57.13

### Unit Selection JKW-350

RATIO	IEEE METERING	IEEE RELAY ACCURACY CLASS <sup>2</sup>	THERMAL RATING FACTOR	CATALOG NUMBER
25/50:5	0.3 B1.8	T200/T400	2.0/1.5	759X030013 <sup>3</sup>
50/100:5	0.3 B1.8	T200/T400	2.0/1.5	759X030012 <sup>3</sup>
75/150:5	0.3 B1.8	T200/T400	2.0/1.5	759X030011
100/200:5	0.3 B1.8	T200/T400	2.0/1.5	759X030010 <sup>3</sup>
150/300:5	0.3 B1.8	T200/T400	2.0/1.5	759X030009 <sup>3</sup>
200/400:5	0.3 B1.8	T200/T400	2.0/1.5	759X030008 <sup>3</sup>
300/600:5	0.3 B1.8	T200/T400	2.0/1.5	759X030007 <sup>3</sup>
400/800:5	0.3 B1.8	T200/T400	2.0/1.5	759X030006 <sup>3</sup>
500/1,000:5	0.3 B1.8	T200/T400	2.0/1.5	759X030005 <sup>3</sup>
600/1,200:5	0.3 B1.8	T200/T400	2.0/1.5	759X030004 <sup>3</sup>
800/1,600:5	0.3 B1.8	T200/T400	2.0/1.5	759X030003 <sup>3</sup>
1,000/2,000:5	0.3 B1.8	T200/T400	2.0/1.5	759X030002 <sup>3</sup>
1,500/3,000:5	0.3 B1.8	T400/T800	1.5/1.33	759X030001 <sup>3</sup>

1. High accuracy options available

2. First value given is for lower primary Ampere rating (tapped secondary); second value is for higher primary Ampere rating (full secondary).

3. Measurement Canada Approval: T-0117



**Advanced, Rugged Construction**

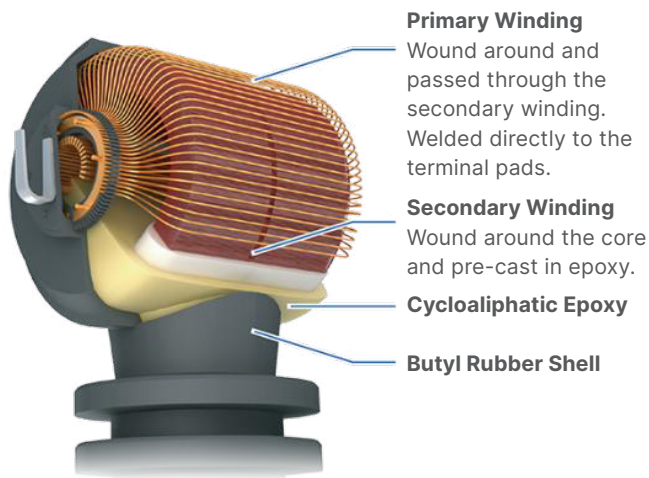

*Cross-Section View of a Station-Class SUPERBUTE Current Transformer*

**Tough & Resilient Butyl Rubber Shell**

First introduced in 1955, HY-BUTE 60™ is GE Vernova's unique butyl rubber formula. This material is hydrophobic, non-arc tracking, resistant to heat, chemicals, ozone and ultraviolet and is an elastic rubber which does not easily chip or crack. Use of HY-BUTE 60 enhances safety by increasing the likelihood of a passive, contained failure mode.

**Accurate & Reliable Primary Design**

Symmetrical distribution of winding turns within the CT head shell minimizes leakage flux for improved accuracy and thermal ratings

**Built-in Surge Protection**

A unique multi-gap primary on CT's 600 amps and below is designed to clear dangerous overvoltage and fault conditions within ½ cycle

**High Overcurrent Capability**

The robust primary bar design on CT's rated above 600 amps has virtually unlimited short-time mechanical current withstand

**Reference Drawings & Accessories JKW-350**

ACCURACY CURVES AT 60 Hz (LOW RATING):		OVERCURRENT CURVES (LOW RATING):	
25/50:5 thru 300/600:5	9689241435	25/50:5 thru 300/600:5	9689241440
400/800:5	9689241407	400/800:5	9689241431
500/1,000:5	9689241405	500/1,000:5	9689241429
600/1,200:5	9689241403	600/1,200:5	9689241427
800/1,600:5	9689241401	800/1,600:5	9689241425
1,000/2,000:5	9689241399	1,000/2,000:5	9689241423
1,500/3,000:5	9689241397	1,500/3,000:5	9689241421
ACCURACY CURVES AT 60 Hz (HIGH RATING):		OVERCURRENT CURVES (HIGH RATING):	
25/50:5 thru 300/600:5	9689241436	25/50:5 thru 300/600:5	9689241441
400/800:5	9689241408	400/800:5	9689241432
500/1,000:5	9689241406	500/1,000:5	9689241430
600/1,200:5	9689241404	600/1,200:5	9689241428
800/1,600:5	9689241402	800/1,600:5	9689241426
1,000/2,000:5	9689241400	1,000/2,000:5	9689241424
1,500/3,000:5	9689241398	1,500/3,000:5	9689241422
EXCITATION CURVES:		OUTLINE DRAWINGS:	
25/50:5 thru 300/600:5	9689241338	25/50:5 to 300/600:5	
400/800:5	9689241354	Single Ratio	9926780009
500/1,000:5	9689241352	Tap Ratio	9926780017
600/1,200:5	9689241350	400/800:5 to 1,500/3,000:5	
800/1,600:5	9689241348	Single Ratio	9926780010
1,000/2,000:5	9689241346	Tap Ratio	9926780008
1,500/3,000:5	9689241344	Dual/Tapped Ratio	9926362001
		Multi-Ratio	9932478

**JKW-350 Applicable Wiring Diagrams**

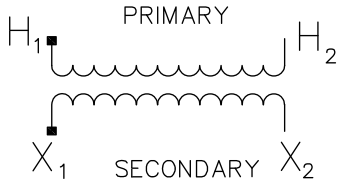
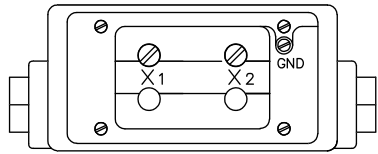

Single Secondary  
(Two secondary terminals)

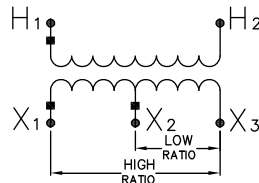
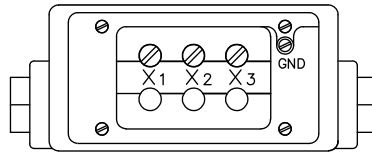

Tapped Secondary (Default)  
(Four secondary terminals)

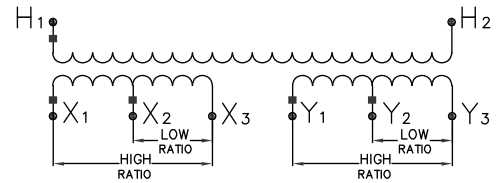
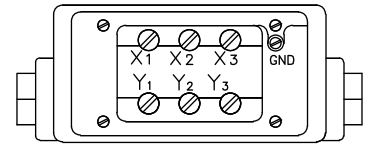

Dual-Tapped Secondary  
(Six secondary terminals)

**Typical Nameplate**

**Current Transformer** Type **JKW-350**

**Bil 350 kV NSV**      **69.0 kV**      **50-60 Hz**

Conn X2-X3 Ratio 200:5 Amp  
(Conn X1 Open)  
RF=2.0 @ 30°C Amb  
Acc Cl @ 60 Hz 0.3 B-0.1 Thru B-1.8, T200

Caution: Read GEH-230  
Somersworth, NH USA

**Cat. 759X030008**  
APPR# T-0117

Ser. **1047763**  
Mfd. 12 14  
wt. 590 Lbs.

**Outline Dimensions – Up to and including 600 A**

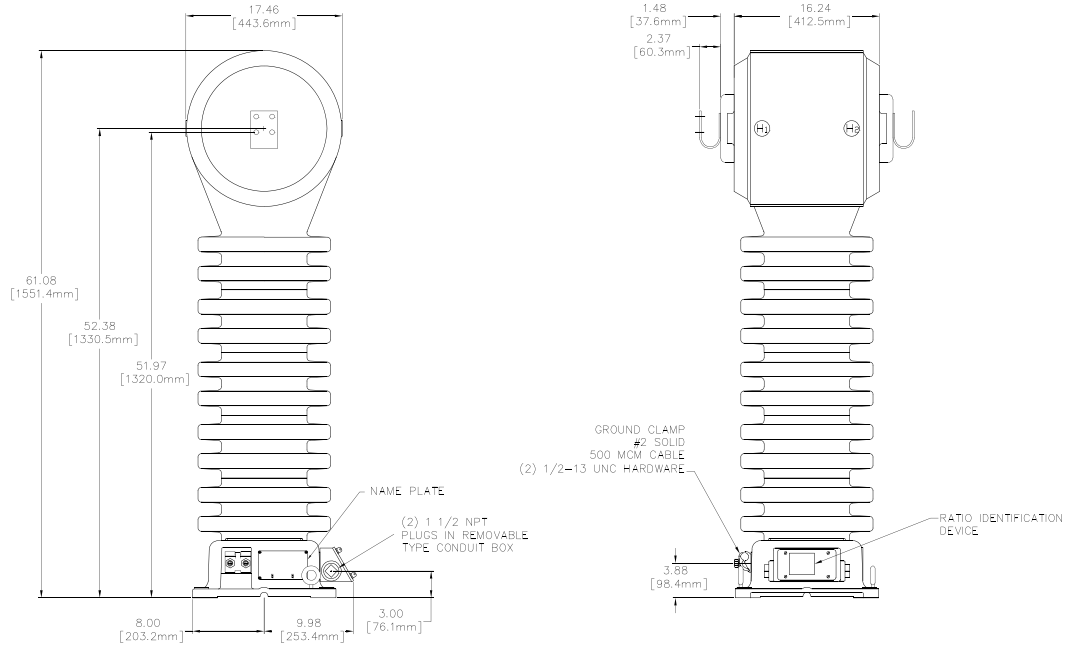

**Outline Dimensions – Above 600 A**

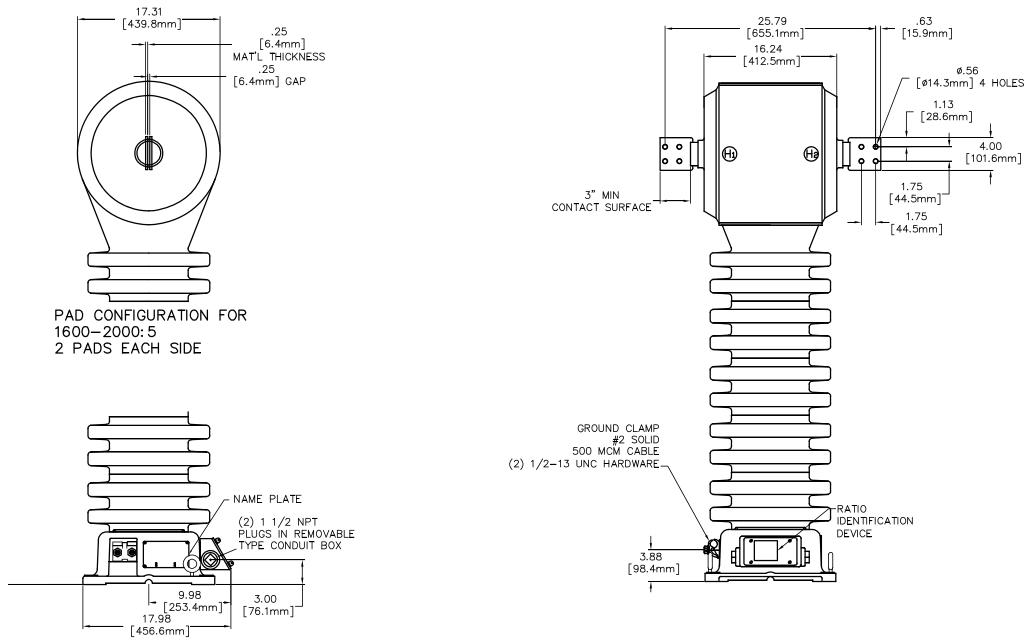

### Mounting Plate & Primary Terminal Configurations

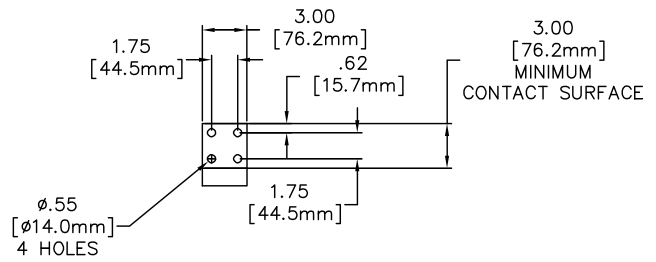
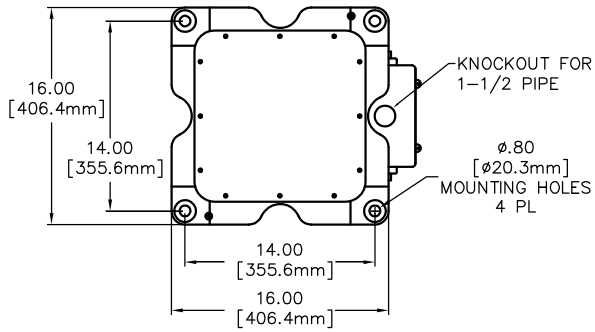

Primary - 1 PAD, up to 600A

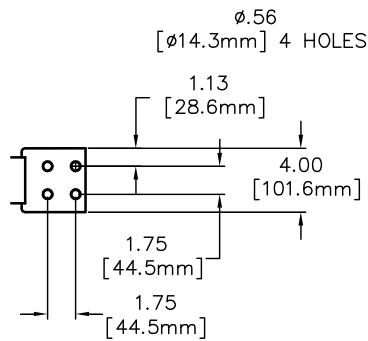

Primary - 1 and 2 PAD, up to 2000A

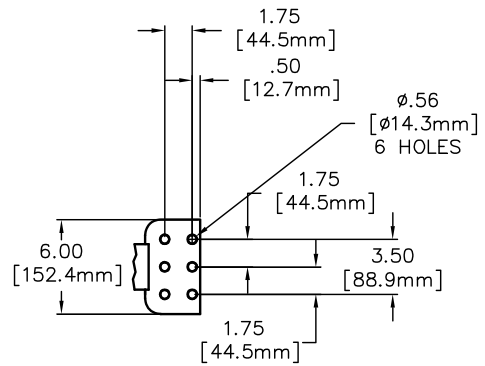

Primary - 3 PAD, up to 3000A

### Pad Configurations – Above 600:5A

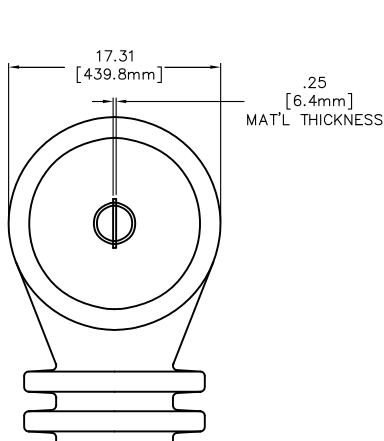

PAD CONFIGURATION FOR  
800:5–1200:5  
1 PAD EACH SIDE

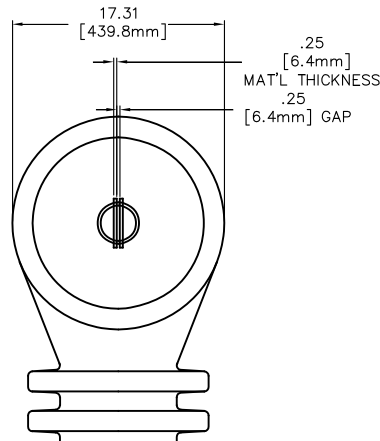

PAD CONFIGURATION FOR  
1600–2000:5  
2 PADS EACH SIDE

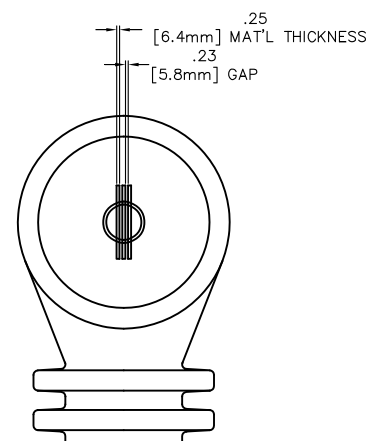

PAD CONFIGURATION FOR  
3000:5  
3 PADS EACH SIDE

## Construction Details

### Insulation

The transformer design is constructed using GE Vernova's premium HY-BUTE 60™ molded butyl rubber insulation for the transformer body. First introduced in 1955, GE Vernova's unique formulation is non-arc tracking and resistant to heat, chemicals, ozone and ultraviolet. This tough, resilient insulating material has proven to be superior in handling mechanical, electrical and environmental extremes, when compared against other insulation designs such as porcelain, urethane or epoxy.

### Core

The core is made from high-quality, grain-oriented, low-loss, high permeability silicon steel which is carefully selected and tested under rigidly controlled factory conditions. The core is wound in the direction of the grain to take advantage of the high permeability.

### Bushings

Since the bushings are an integral part of the transformer, standards normally pertaining to porcelain bushing tests do not apply. However, characteristics equal to, or better than, those required for porcelain are provided.

### Primary Windings

The primary winding is mounted in the high-voltage bushing head shell, which results in a more efficient use of the core properties by permitting a symmetrical distribution of the winding turns. It keeps leakage to a minimum, and makes possible a high level of accuracy with fewer ampereturns and corresponding improvement in thermal rating. In transformers rated 600:5 A and lower, a multi-turn primary winding is used, consisting of equally distributed copper conductors which encircle the core and secondary winding. In transformers rated 800:5 A and above, a single-turn, copper primary bar is used.

### Primary Terminals

Transformers rated 600:5 Amperes and below have a U-shaped pad for the primary terminals. Transformers rated 800:5 Amperes and above use a vertically-oriented, flat copper bar for the primary terminal pads. In both cases, the terminal pads contain four mounting holes with industry standard hole sizes and spacing.

### Secondary Winding

The secondary winding is wound with enamel-insulated copper conductor. All turns are evenly distributed around the core, and suitable compensation is used to obtain very high accuracy performance. The secondary leads extend downward through the bushing tube to the secondary terminal block in the transformer base.

### Secondary Terminals

The secondary terminals are enclosed in a box secured to the base of the transformer with four, 1/4 -20 screws. Both the box and terminal block can be relocated to any of three sides of the base to fit the particular installation. The terminal box has 1 1/2 inch threaded conduit openings at each end, and a 1 1/2 inch knockout at the bottom. It is also provided with a grounding terminal for the secondary circuit, when required.

### Testing

Rigorous GE Vernova test requirements go beyond IEEE routine requirements in order to ensure long term reliability. Test reports are saved electronically and can be e-mailed in various formats upon request.

### Polarity

The permanently molded primary polarity markings H1 and H2 and the secondary polarity markings X1 and X2 are situated adjacent to their respective terminals. The polarity terminal is designated by use of the subscript 1, and the mark is painted white for better visibility.

### Baseplate and Mounting

Transformers can be mounted in any position from upright to inverted, providing the centerline of current transformers through the primary terminals is parallel with the ground surface. Loading by lines or busswork should be kept to a maximum to avoid placing appreciable strain upon the transformer bushings and terminals. The maximum recommended loading from all sources should not be greater than the equivalent of a 200-pound external force applied at the axis of the primary terminals. A fabricated metal base is the supporting structure for the transformer. It is provided with four 13/16 inch mounting holes and two lifting eye- bolts. Adjacent to the nameplate is a standard two- bolt ground connector.

### Nameplate

The nameplate is made of stainless-steel and located on the base of the transformer. Information is per IEEE designation, laser-engraved for easy-to-read form. Custom barcoding available upon request.

### Maintenance

These transformers require no maintenance other than an occasional cleaning if installed in an area where air contamination is severe.

For more information, visit  
[governova.com/grid-solutions](https://www.governova.com/grid-solutions)

Instrument Transformers LLC reserve the right to change specifications of described products at any time without notice and without obligation to notify any person of such changes.

© 2025 GE Vernova and/or its affiliates. All rights reserved. GE and the GE Monogram are trademarks of General Electric Company used under trademark license.



GEA-N50629  
English  
251022